

**FOX RUN
PHASE 1
PLAT BOOK 7, PAGE 39, MARTIN
COUNTY, FLORIDA**

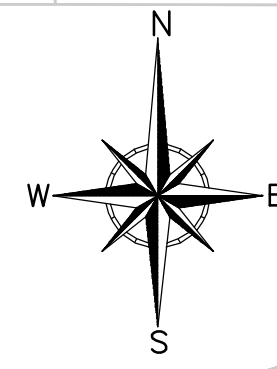

**Denotes Primary
Drainage
Improvements**

**Denotes
Vegetation to
remain or be
restored**

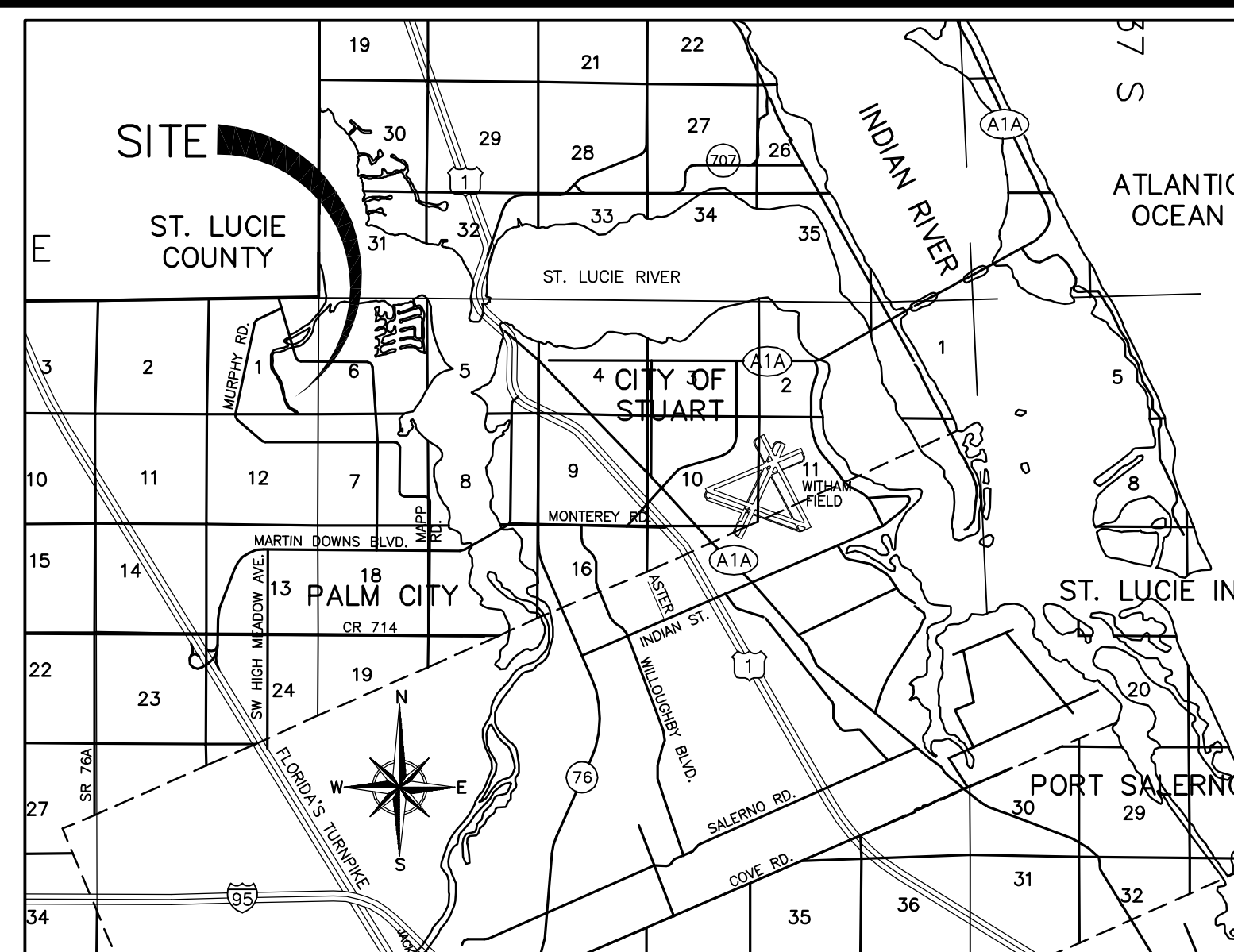

LOCATION MAP
(NOT TO SCALE)

SYMBOL LEGEND
× 11.47 FIELD LOCATED POINT WITH ELEVATION

ABBREVIATIONS
CL CENTERLINE
CONC. CONCRETE
CMP CORRUGATED METAL PIPE
EL. ELEVATION
INV. INVERT
FND. FOUND
HDPE HIGH DENSITY POLYETHYLENE
IR&TC IRON ROD & TRAVERSE CAP
LB LICENSED BUSINESS
NO. NUMBER
PT. POINT
PK&W PARKER KALON NAIL & WASHER
P.L.S. PROFESSIONAL LAND SURVEYOR
RNG. RANGE
SEC. SECTION
TRAV. TRAVERSE
TWP. TOWNSHIP
T.O.P. TOP OF PIPE

SURVEYOR'S NOTES

- BEARINGS AS SHOWN HEREON ARE BASED ON STATE PLANE COORDINATES, NORTH AMERICAN DATUM OF 1983 (N.A.D. 83), FLORIDA EAST ZONE, REFERENCE A BEARING OF S00°11'06"W ALONG A LINE BETWEEN TWO ONSITE TEMPORARY BENCHMARKS.
- ELEVATIONS AS SHOWN HEREON REFERENCE THE NATIONAL GEODETIC VERTICAL DATUM OF 1929 (N.G.V.D. 29), REFERENCE MARTIN COUNTY BENCHMARKS "BESSEY-1" ELEVATION = 8.915 FEET AND "MMM-1", ELEVATION = 12.836 FEET.
- THIS SURVEY WAS DONE WITHOUT THE BENEFIT OF A TITLE COMMITMENT.
- THIS SURVEY IS BASED ON A CLOSED GEOMETRIC FIGURE EXCEEDING A HORIZONTAL CLOSURE OF 1:10,000.
- THERE WAS NO ATTEMPT TO LOCATE ANY SUBSURFACE FOUNDATIONS.
- NO UNDERGROUND UTILITIES WERE LOCATED OR SHOWN HEREON.
- THIS SURVEY IS NOT VALID WITHOUT THE SIGNATURE AND ORIGINAL RAISED SEAL OF A FLORIDA LICENSED SURVEYOR.
- THIS PROPERTY IS LOCATED IN FEDERAL FLOOD ZONE AE (EL 7), REFERENCE FEMA MAP COMMUNITY NO. 120161, PANEL 0133, SUFFIX F, EFFECTIVE DATE OCTOBER 4, 2002.
- THIS IS NOT A BOUNDARY SURVEY.
- THE PURPOSE OF THIS SURVEY IS TO IDENTIFY THE LOCATIONS AND ELEVATIONS OF CATCH BASINS.
- THE SURVEY DATA WAS OVERLAID UNTO MARTIN COUNTY PARCEL MAP SHAPE FILE AND THE 2009 HIGH RESOLUTION IMAGES OBTAINED FROM LABINS.

SURVEYOR'S CERTIFICATE

I HEREBY CERTIFY THAT THE "SPECIFIC PURPOSE SURVEY" AS SHOWN HEREON IS A TRUE AND CORRECT REPRESENTATION OF A FIELD SURVEY MADE UNDER MY DIRECTION AND CHARGE ON MAY 24, 2011 AND SAID "SPECIFIC PURPOSE SURVEY" IS TRUE AND ACCURATE TO THE BEST OF MY KNOWLEDGE AND BELIEF. IT IS FURTHER CERTIFIED THAT THIS "SPECIFIC PURPOSE SURVEY" COMPLIES WITH THE MINIMUM TECHNICAL STANDARDS FOR "SPECIFIC PURPOSE SURVEY" SET FORTH BY THE FLORIDA BOARD OF PROFESSIONAL SURVEYORS AND MAPPERS IN CHAPTER 5J-17, FLORIDA ADMINISTRATIVE CODE, PURSUANT TO SECTION 472.027, FLORIDA STATUTES.

BETSY LINDSAY, INC.
SURVEYING AND MAPPING

ELIZABETH A. LINDSAY, P.L.S. NOT VALID WITHOUT THE SIGNATURE AND ORIGINAL RAISED SEAL OF A FLORIDA LICENSED SURVEYOR AND MAPPER
FLORIDA REGISTRATION NO. 4724

B BETSY LINDSAY, INC.
SURVEYING AND MAPPING
7997 S.W. JACK JAMES DRIVE STUART, FLORIDA 34997
(772)286-5753 (772)286-5533 FAX
LICENSED BUSINESS NO. 6852

DATE	REVISIONS

DATE 05/24/11
SCALE 1"=60'
FIELD BK. BILL D. 2
DRAWN BY C.R.
CHECKED BY E.A.L.

FOX RUN - SEC 12, TWP 38 SOUTH, RNG 40 EAST
MARTIN COUNTY, FLORIDA

SPECIFIC PURPOSE SURVEY
EVERGREEN ENGINEERING, INC.

SHEET NO. 1
OF 1 SHEETS
PROJECT NO. 11-35