

"TRAV PT. LB 6852"  
EL. = 7.48'

# FOX RUN

## PHASE 1

PLAT BOOK 7, PAGE 39, MARTIN COUNTY, FLORIDA

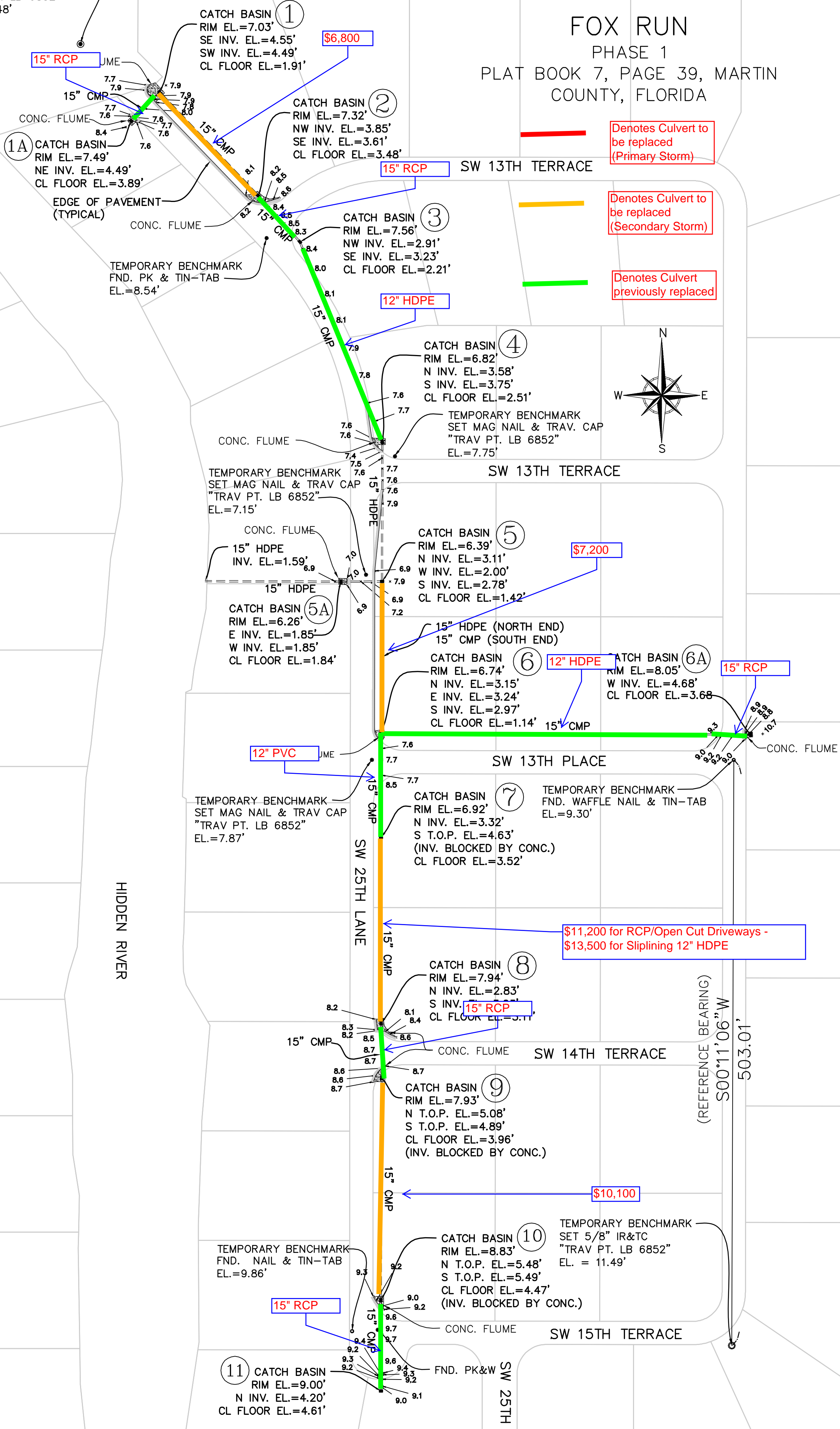

Denotes Culvert to be replaced (Primary Storm)

Denotes Culvert to be replaced (Secondary Storm)

Denotes Culvert previously replaced

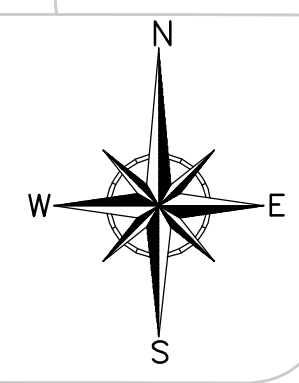

\$7,200

\$11,200 for RCP/Open Cut Driveways - \$13,500 for Sliplining 12" HDPE

\$10,100

\$6,800

CATCH BASIN ①  
RIM EL.=7.03'  
SE INV. EL.=4.55'  
SW INV. EL.=4.49'  
CL FLOOR EL.=1.91'

CATCH BASIN ②  
RIM EL.=7.32'  
NW INV. EL.=3.85'  
SE INV. EL.=3.61'  
CL FLOOR EL.=3.48'

CATCH BASIN ③  
RIM EL.=7.56'  
NW INV. EL.=2.91'  
SE INV. EL.=3.23'  
CL FLOOR EL.=2.21'

CATCH BASIN ④  
RIM EL.=6.82'  
N INV. EL.=3.58'  
S INV. EL.=3.75'  
CL FLOOR EL.=2.51'

CATCH BASIN ⑤  
RIM EL.=6.39'  
N INV. EL.=3.11'  
W INV. EL.=2.00'  
S INV. EL.=2.78'  
CL FLOOR EL.=1.42'

CATCH BASIN ⑥  
RIM EL.=6.74'  
N INV. EL.=3.15'  
E INV. EL.=3.24'  
S INV. EL.=2.97'  
CL FLOOR EL.=1.14'

CATCH BASIN ⑦  
RIM EL.=6.92'  
N INV. EL.=3.32'  
S T.O.P. EL.=4.63'  
(INV. BLOCKED BY CONC.)  
CL FLOOR EL.=3.52'

CATCH BASIN ⑧  
RIM EL.=7.94'  
N INV. EL.=2.83'  
S INV. EL.=3.11'  
CL FLOOR EL.=3.11'

CATCH BASIN ⑨  
RIM EL.=7.93'  
N T.O.P. EL.=5.08'  
S T.O.P. EL.=4.89'  
CL FLOOR EL.=3.96'  
(INV. BLOCKED BY CONC.)

CATCH BASIN ⑩  
RIM EL.=8.83'  
N T.O.P. EL.=5.48'  
S T.O.P. EL.=5.49'  
CL FLOOR EL.=4.47'  
(INV. BLOCKED BY CONC.)

CATCH BASIN ⑪  
RIM EL.=9.00'  
N INV. EL.=4.20'  
CL FLOOR EL.=4.61'

1A CATCH BASIN  
RIM EL.=7.49'  
NE INV. EL.=4.49'  
CL FLOOR EL.=3.89'

TEMPORARY BENCHMARK  
FND. PK & TIN-TAB  
EL.=8.54'

TEMPORARY BENCHMARK  
SET MAG NAIL & TRAV CAP  
"TRAV PT. LB 6852"  
EL.=7.15'

CATCH BASIN ⑤A  
RIM EL.=6.26'  
E INV. EL.=1.85'  
W INV. EL.=1.85'  
CL FLOOR EL.=1.84'

TEMPORARY BENCHMARK  
SET MAG NAIL & TRAV CAP  
"TRAV PT. LB 6852"  
EL.=7.87'

TEMPORARY BENCHMARK  
FND. WAFFLE NAIL & TIN-TAB  
EL.=9.30'

(REFERENCE BEARING)  
S00°11'06"W  
503.01'

HIDDEN RIVER

SW 25TH LANE

SW 15TH TERRACE

SW 14TH TERRACE

SW 13TH PLACE

SW 13TH TERRACE

SW 13TH TERRACE